

5/8/17 e-mailed



Macon County
Public Health

**CONSTRUCTION AUTHORIZATION
ON-SITE WASTEWATER**

| | | | | | |
|------------------------|---|---------------------|---------------------------------------|--------------------|---------------------|
| Applicant/Owner | Dreda Lou Cannon | Log # | 033917-S | PDWW# | N/A |
| Location | 8242 Highlands Rd. | PID # | 7522089872 | ACREAGE | 8.12 |
| Directions | Highlands Road to 8242 Highlands Rd. on L | | | | |
| Design | 480 Gallons Per Day | Facility | Existing 4 BR House | Permit Type | 100% Repair |
| Foundation | Crawlspace | Water Source | Existing Single-Family Well / On Site | Expiration | Valid for 60 Months |

Permit Conditions

System must be installed level and on contour by a certified installer.

Septic and pump tank shall be leak tested and shall be no closer than 25 feet from the creek. Where 50 feet from the well cannot be maintained with the supply line the supply line must be encased in ductile iron but not to be closer than 25 feet to the well. Must meet all other .1950 setbacks. Call MCPH with any questions.

Diagram (Not to Scale)

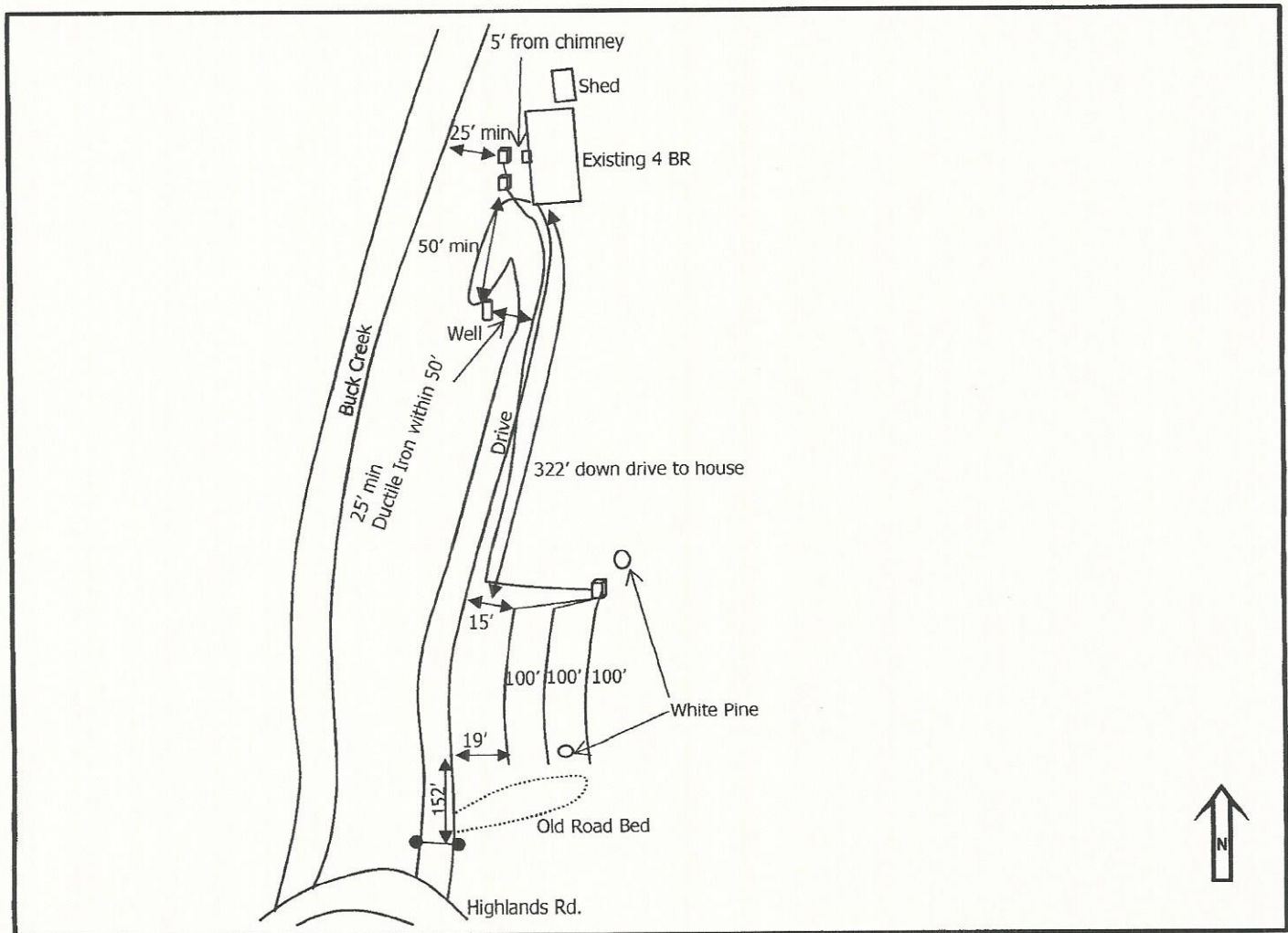

| | | | | | | | | |
|-----------------------------------|-----------------------------------|-------------------|--------------------|------------------|---------------|--------------------------|--------------------|------------------|
| TO BE INSTALLED | 24" Wide Chamber – Effluent Pump; | | | | REPAIR | – Not Applicable; | | |
| Type IIIb | Soil Depth: 44(in) | Slope: 60% | LTAR: 0.55 | Saprolite: No | Type | Area: (ft ²) | LTAR: | Saprolite: |
| CONSTRUCTION AUTHORIZATION | TOTAL LENGTH | # OF LINES | MIN SPACING | MAX DEPTH | WIDTH | DISTRIBUTION | SEPTIC TANK | PUMP TANK |
| | 300' | 3 | 6' on center | 18" low side | 24 inches | Serial Feed | 1000 gallon | 1000 gallon |

The issuance of this permit by MCPH in no way guarantees the issuance of other permits. The permit holder is responsible for checking with appropriate governing bodies in meeting their requirements. This permit is subject to revocation if the site plan, plat, site or intended use changes. This permit is subject to compliance with the provisions of the NC Laws and Rules for Sewage Treatment and Disposal and to the conditions of this permit. Construction and installation Rules NCAC .1950, .1952, .1954, .1955, .1956, .1957, .1958 and .1959 are incorporated by reference into this permit and shall be met. **Questions? (828) 349-2490**

Issue Date: 5/8/2017

Darrell McDaniels, REHSI 2552

Authorized State Agent